

BOLTED SPLICE ASSEMBLY GUIDE

HSS - TO - HSS TRUSS CHORD

NOTE:

DIAGRAM SHOWN FOR GENERAL REFERENCE ONLY
SEE BRIDGE DESIGN DRAWINGS FOR BOLT COUNT, SIZE, AND PLACEMENT

THE METHOD AND SEQUENCE OF SPLICING IS THE RESPONSIBILITY OF THE ERECTOR
AND IS DEPENDENT UPON SUCH ITEMS AS SITE CONDITIONS, ACCESSIBILITY, EQUIPMENT, AND MANPOWER.

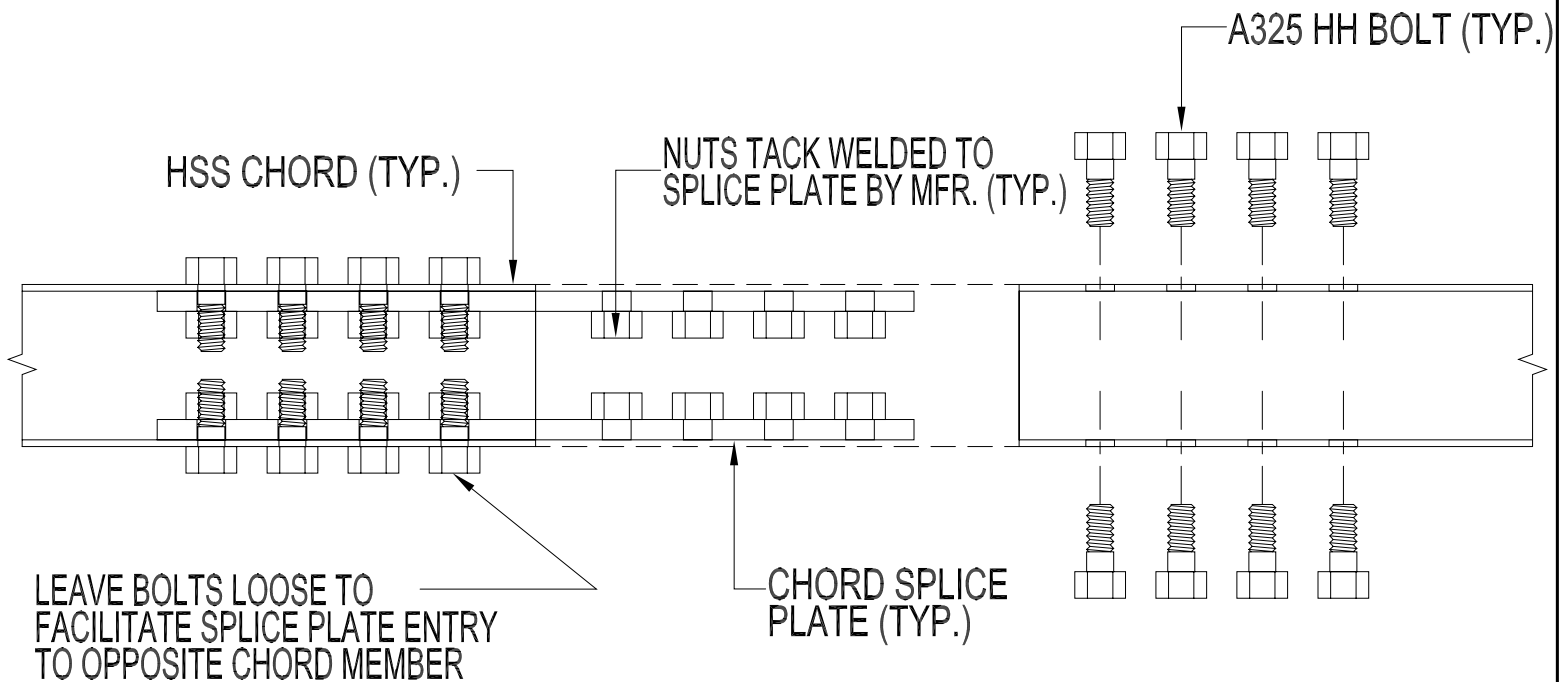

NOTE:

START ALL BOLTS IN EACH SPLICE LOCATION AND ENSURE PROPER BRIDGE ALIGNMENT
AND FIT BEFORE BRINGING THEM TO THE REQUIRED FINAL TIGHTENED CONDITION

ALL CONNECTIONS SHALL UTILIZE "TURN-OF-THE-NUT" TIGHTENING AS DETAILED
IN THE RSCS "SPECIFICATION FOR STRUCTURAL JOINTS USING ASTM A325 OR A490 BOLTS."